

BUILD A SMARTER BATTERY, NOT A BIGGER BATTERY

Storz Power's Artificial Intelligence (AI) technology enables you to do more with less and be a better steward of utilizing Earth's natural resources.

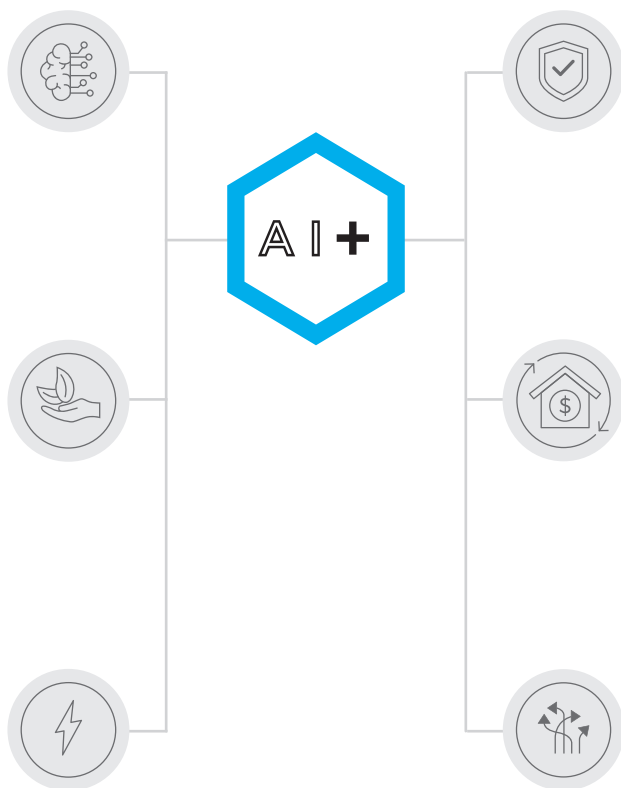

SMART

- AI+ technology enables you to do more with less
- Smart Access allows you to choose how your energy is used - all at fingertips

SUSTAINABLE

- Reduces the burden on the earth's natural resources
- Produces zero emissions
- Generates and stores energy from the sun

POWERFUL

- Offers the most powerful whole home battery system on the market
- Empowers you with energy independence
- Enables you to have complete control of how you want to use your energy
- Live with the peace of mind that your home energy is backed up when the power is out

SAFE

- Lithium-Iron Phosphate (LFP)
- Rigorously tested, UL 1973 & UL 9540.
- ETL / Intertek listed, tested, and passed
- Securely power your home even when the grid power is out

ECONOMICAL

- Reduces power conversion losses
- Reduces materials and labor required for your ESS system
- Increases the life of your investment with our AI+ technology system management and robust warranty

FLEXIBLE

- AC and DC coupling
- Solar and generator ready
- Stack 1-12 inverters
- Stack 1-14 batteries in parallel per inverter
- Unlimited expansion of Smart Access panels
- Build a custom package with the AI+ Custom Whole Home solution
- Add extra system components to any package initially or in the future



PACKAGES

Storz Power AI+ packages boast flexible home energy options that can power just your essentials or your whole home, regardless of size, in the event of a power outage or emergency. The Storz Power lithium-iron phosphate (LFP) battery and inverter matched with the Smart Access controller are what makes our AI+ packages the most flexible, safe, and powerful energy storage systems that exist today.

AI+ 30A

UP TO 30 AMPS

This package offers fundamental security for small homes. Power things like your fridge, select lights, internet router, and fans.

1 Battery
5.12 kWh

1 5K Inverter
2.5-6.5kW PV



*This package is not yet available in CA



AI+ 30A PLUS

UP TO 30 AMPS

This package offers fundamental security for small homes looking for additional back up time. Power things like your fridge, select lights, internet router, and fans.

2 Batteries
10.24 kWh

1 5K Inverter
2.5-6.5kW PV



*This package is not yet available in CA



AI+ 50A

UP TO 50 AMPS

This is the perfect starter package to power your home essentials in case of an emergency. Power things like your fridge, microwave, lights throughout, garage door, internet router, and fans.

2 Batteries
10.24 kWh

1 12K Inverter
2.5-13kW PV



AI+ 70A SMART ACCESS

UP TO 70 AMPS

Access more than just your basics and choose where to use your home's power in real-time. Power all the energy consuming items in the AI+ 50A package plus the water heater, EV charger, and well pump.

3 Batteries
15.36 kWh

1 12K Inverter
2.5-13 kW PV

1 Smart Access
Panel



AI+ 200A SMART ACCESS

UP TO 200 AMPS

Access power to your entire 200 amp main panel and choose where to use your home's power in real-time. Power all the energy consuming items in the AI+ 70A Smart Access package plus the AC, computers, electric oven/range, and pool pump.

4 Batteries
20.48 kWh

1 12K Inverter
2.5-13 kW PV

1 Smart Access
Panel

1 AI+ Smart Switch

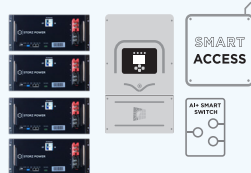

AI+ CUSTOM WHOLE HOME

UP TO 600 AMPS

Access your entire home off-grid or in a blackout with a custom package, no need to choose where to use it. Power all the energy consuming items in the AI+ 200A Smart Access package plus any other items needed to power in a large home of any size.

4+ Batteries
20.48+ kWh

2+ 12K Inverters
5-26+ kW PV

1+ Smart Access
Panel

1 AI+ Smart Switch

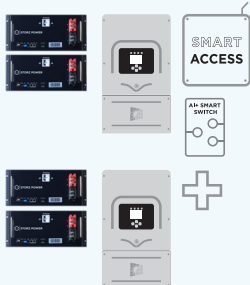



3 TYPES OF INSTALL CONFIGURATIONS

DC COUPLED CONFIGURATION

NEW SYSTEM

A DC coupled PV array is when strings of solar panels are directly connected to a battery inverter. When installing a new PV array, the AI+ Storz Power system can be your direct PV solution up to 13 kW DC. This reduces cost of additional AC coupled inverters as well as speeds up installation, reducing labor cost, and is able to meet all NEC17 Panel Level Shut-down requirements. This configuration is generator ready.

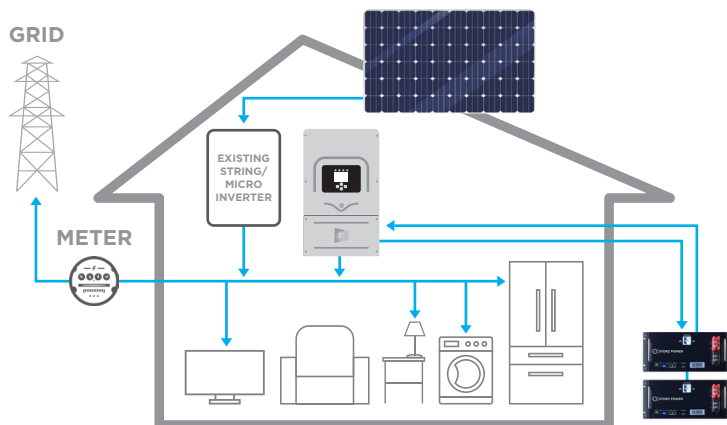
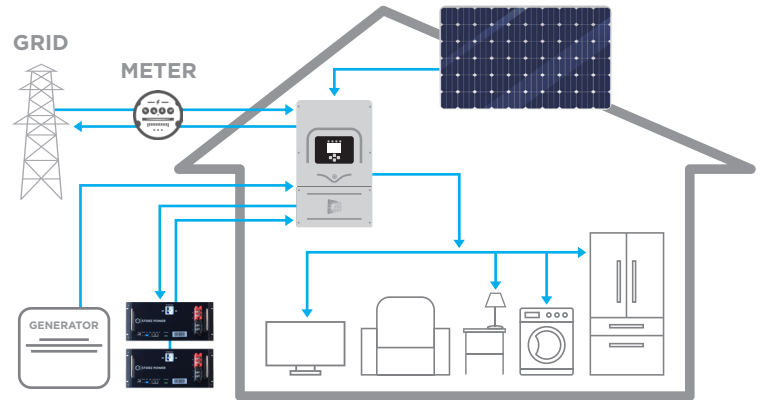

AC COUPLED CONFIGURATION

EXISTING SYSTEM

Keep the PV array active as well when the grid fails with Storz Power's energy storage system!

Your existing system could come with many different existing solar or micro inverters. With Storz Power, you can retrofit any system even if it is 10 years old. This not only gives you access to batteries in an outage but it also will give full access to the PV on the rooftop as well. Don't let your investment of string or micro inverters go to waste.

AC & DC COUPLED AT THE SAME TIME

NEW OR EXISTING SYSTEM

Even more performance than ever! If you have an existing PV array but need more power and want battery backup, no worries. AC couple the existing PV array and simply DC couple the added PV right into the Storz Power AI+ inverter. This reduces significant cost where the competitors would require multiple total systems.

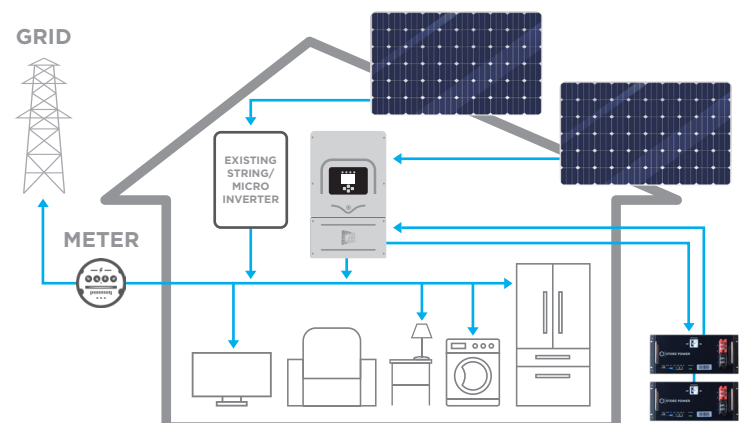



*AI+ 30A & AI+ 30A Plus packages are not yet offered in CA

STORZ POWER SYSTEM LEVEL SPECIFICATIONS

MODEL NUMBERS	AI+ 30A	AI+ 30A PLUS	AI+ 50A	AI+ 70A SMART ACCESS	AI+ 200A SMART ACCESS	AI+ CUSTOM WHOLE HOME
Battery Model Number	SP5.12-LFPv4					
Inverter Model Number	5K Inverter		12K Inverter			
Smart Access Model Number	SmartAccess_ID					
AI+ Smart Switch	RDT-CFNC-0200A-QS7					

PACKAGES

Total Energy Capacity Included	1 Battery (5.12 kWh)	2 Batteries (10.24 kWh)	2 Batteries (10.24 kWh)	3 Batteries (15.36 kWh)	4 Batteries (20.48 kWh)	168 Batteries (860.16 kWh max)
Usable Energy Capacity Included	1 Battery (5.12 kWh)	2 Batteries (10.24 kWh)	2 Batteries (10.24 kWh)	3 Batteries (15.36 kWh)	4 Batteries (20.48 kWh)	168 Batteries (860.16 kWh max)
Battery Expandability *add additional batteries to any package, up to 14 batteries per 12K Inverter	Up to 14 Batteries in Parallel (71.68 kWh)					Up to 14 Batteries per Inverter
Inverter Quantity Included	1 5K Inverter	1 5K Inverter	1 12K Inverter	1 12K Inverter	1 12K Inverter	Stack 1-12 12K Inverters per Home
Total Smart Access Included	Optional Smart Access Panel Add-on			1 Smart Access Panel (12 Breakers)	1 Smart Access Panel (12 Breakers)	Purchase as Many as Needed
Total AI+ Smart Switch Included	Optional AI+ Smart Switch Add-on				1 AI+ Smart Switch	

POWER / OUTPUT

Nominal Cont. AC Power On Grid @240v	5,000W 20.8A	9,000 37.5A	9,000 37.5A<
Nominal Cont. AC Power Off Grid @240v	5,000W 20.8A	9,000 37.5A	9,000 37.5A<
On Grid Pass Through @240v	15,120W 63A		15,120W 63A<
Surge AC Power @240v	16,000VA (10 sec)		
Nominal AC Voltage / Range	120/240 @ 60/50Hz		120/240/208(inv #2,3,6,9,12) @ 60/50Hz
Max. Charging Current (A)	120A	185A	185A<
Max Discharging Current (A)	120A	185A	185A<
Response Time (Grid-tied to Off-grid)	4ms		
AC/DC Coupling	Yes		
Number of MPPT's / Strings	2 / 4		4-24<
Solar Ready & Generator Ready	Yes		
Inverter Supplies String Inverter/Micro Inverter	Yes, to Keep Solar Live in a Power Outage		
Max. DC PV Input Power (W)	6500W	13,000W	
Max. DC Input Voltage (V)	500V		

STORZ POWER SYSTEM LEVEL SPECIFICATIONS

POWER / OUTPUT continued	AI+ 30A	AI+ 30A PLUS	AI+ 50A	AI+ 70A SMART ACCESS	AI+ 200A SMART ACCESS	AI+ CUSTOM WHOLE HOME
MPPT Range (V)				150-425V		
Start-up Voltage (V)				125V		
Max. AC Couple Input (Micro/String Inverter)				9600W		
Support	Islanding, Grid Sell, Self Consumption, Prioritized Charging from Renewables, Grid Support - Zero Export, ESS PCS Operation Modes (Import Only, Export Only), Backup Loads Disconnect, Inverter Bypass Switch					

STORZ POWER BATTERY

Battery Chemistry	Lithium-Iron Phosphate (LFP)
Round Trip Efficiency DC-DC	98%
Depth of Discharge	100% (at 1C Rate at 77°F)
Cycle Life	8,000 Cycles at 77°F)
Battery Voltage Range (V)	44V-56V
Battery Terminal Lugs	Parallel Connection Required
Battery Protection Function	Over-charge, Over-discharge, Over-current, Short Circuit, Temperature

SMART ACCESS

Smart Access AC Voltage	Optional Smart Access Panel Add-on	120/240V		
Breaker Quantity per Smart Access Panel	12 Breakers: six 30 amp breakers and six 60 amp breakers			
Smart Access Panels				
> Control as many electrical panels as needed with Smart Access technology	Add additional Smart Access Panels to any package, max amount is unlimited			
Flexibility	Optional Smart Access Panel Add-on	Yes	Yes	Yes
> Choose where you want to use energy				
Energy App Control	Optional Smart Access Panel Add-on	Yes	Yes	Yes
> Turn appliances off & on manually or with a schedule				
Storz Power AI+ Wireless	Optional Smart Access Panel Add-on	Yes	Yes	Yes
> Control multiple sub-panels				

AI+ SMART SWITCH

AI+ Smart Switch Equals Automatic Transfer Switch	Optional AI+ Smart Switch Add-on	Access up to a 200A panel off grid with no interruptions
*generator based transfer switches will not work in place of a AI+ Smart Switch		

INSTALLATION SPECIFICATIONS

Mounting or Installation Type	Battery: Floor Mount, Inverter: Wall Mount, Smart Access: Wall Mount, AI+ Smart Switch: Wall Mount
Enclosure Type	Battery: Indoor, Inverter: NEMA 3R, Smart Access: Indoor, AI+ Smart Switch: NEMA 3R



STORZ POWER SYSTEM LEVEL SPECIFICATIONS

INSTALLATION SPECIFICATIONS continued	AI+ 30A	AI+ 30A PLUS	AI+ 50A	AI+ 70A SMART ACCESS	AI+ 200A SMART ACCESS	AI+ CUSTOM WHOLE HOME
Battery Max. Ambient Operating Temperature Range				14°F to 113°F / -10°C to 45°C		
Battery Recommended Operating Temperature Range				77°F to 87°F / 25°C to 30.6°C		
Battery Operating Humidity (RH)				75%		
Battery Storage Conditions				<86°F, State of Charge 20%-60%		
Inverter Ambient Operating Temperature Range				-13°F - 131°F, >113°F derating / -25°C - 55°C, >45°C derating		
AI+ Smart Switch Recommended Operating Temp. Range		Optional AI+ Smart Switch Add-on				-4°F - 158°F / -20°C - 70°C
AI+ Smart Switch Operating Humidity (RH)		Optional AI+ Smart Switch Add-on				5-95% non-condensing
Cooling	Battery/Smart Access/AI+ Smart Switch: Natural Convection - No Fan Inverter: Active Fan Cooling					
Maximum Installation Altitude (Ft.)	No Limit					

*note: charge/discharge rate may be reduced at temperature extremes

COMPATIBILITY

Battery Compatibility	Most 48V PV Inverter Manufacturers & Grid-tied PV Systems					
Communication from Battery to Inverter	Double RS485					
Battery Supported Communication Interfaces	CANbus, MODbus					
Monitoring Included	Yes					

SIZE & WEIGHT

Battery Dimensions / Weight 1 Battery: 17" x 17" x 8.75" / 124 lb.	24"x22"x27" 178 lb.	24"x22"x27" 302 lb.	24"x22"x27" 302 lb.	23.63"x23.63"x43" 474 lb.	23.63"x23.63"x43" 598 lb.	Custom
Inverter Dimensions / Weight	30" x 18.3" x 10" / 78 lb.					
Smart Access	Optional Smart Access Panel Add-on			15.75" x 15.75" x 4.72" / 33.5 lb.		
AI+ Smart Switch	Optional AI+ Smart Switch Add-on				24.1" x 13.4" x 7" / 18 lb.	

WARRANTY

Battery	Full Repair/Replace: 15 Year Performance Warranty (or 8,000 Cycles at 77°F), 10 Year Product Warranty					
Inverter	5K Inverter 5 Year Standard Warranty		12K Inverter 10 Year Standard Warranty			
Smart Access Panel	Optional Smart Access Panel Add-on			10 Year Limited Warranty		
AI+ Smart Switch	Optional AI+ Smart Switch Add-on				5 Year Limited Warranty	

COMPLIANCE STANDARDS

Battery Safety / Certifications	UL 1642, UN 38.3, ANSI/CAN/UL-1973, UL 9540, CA-SGIP, CEC, OGPc					
Inverter Safety / Certifications	NEC 690.4B, NEC 705.4/6, UL1741-2010/2018, IEEE1547a-2003/2014, FCC 15 class B, UL1741SA, CA Rule 21, HECO Rule 14H, NEC 240.15, NEC 690.5, NEC 690.5, NEC 690.12, NEC 690.11/UL 1699B, PV Input Lightning Protection, AC Input/Output 63A Breakers, Battery Breaker/Disconnect, PREPA					
Smart Access Safety / Certifications	Optional Smart Access Panel Add-on			UL 916/61010		

STORZ POWER SYSTEM LEVEL SPECIFICATIONS

COMPLIANCE STANDARDS continued	AI+ 30A	AI+ 30A PLUS	AI+ 50A	AI+ 70A SMART ACCESS	AI+ 200A SMART ACCESS	AI+ CUSTOM WHOLE HOME
AI+ Smart Switch Safety / Certifications	Optional AI+ Smart Switch Add-on				UL 1008, UL 508, CSA certified, file #LR58301, NFPA 70, NFPA 110, IEEE Standard 446, IC10-1993, ANSI C37.90.1 (IEEE472), EN61000-4-5, EN61000-4-4, CISPR 11, IEC 61000-4-2, IEC 61000-4-3, IEC 61000-4-4, IEC 61000-4-5, IEC 61000-4-6, IEC 61000-4-8, IEC 61000-4-11	
Grid Connection	Worldwide Compatibility					
Emissions	No Emissions / Clean Energy					
ETL Listed / Intertek	Tested and Passed					